



# Repair manual BIOSTAR® 4-Aligner

11 Replacing the switch  
3030.966 / 3030.912

# Replacing ON/OFF switch 3030.966

- 1** DISCONNECT THE DEVICE FROM THE MAINS!

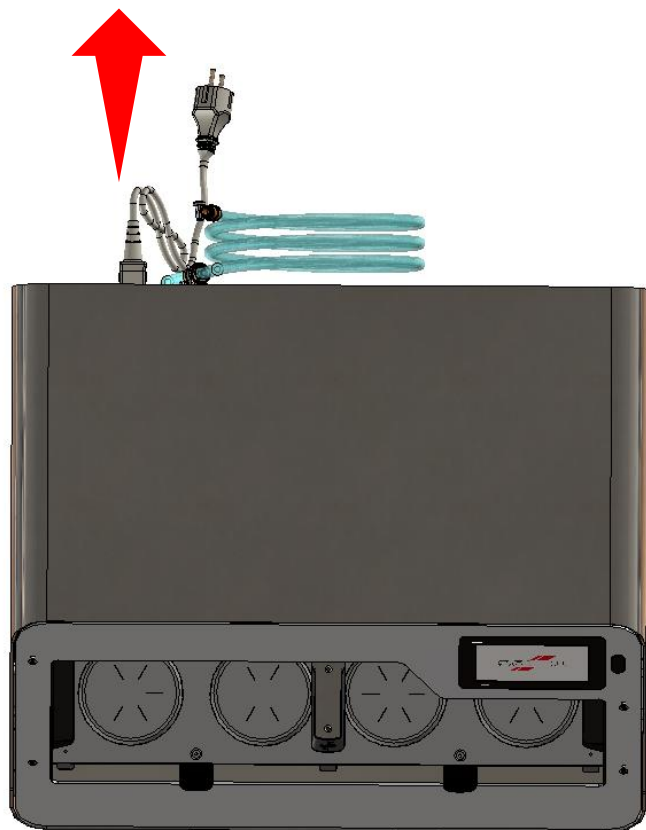

- 2** Turn the device so that you can access the screws on both sides.

Do NOT lift the device by the FRONT PANEL; instead, lift it from underneath!

Make sure that the latest software version is installed.

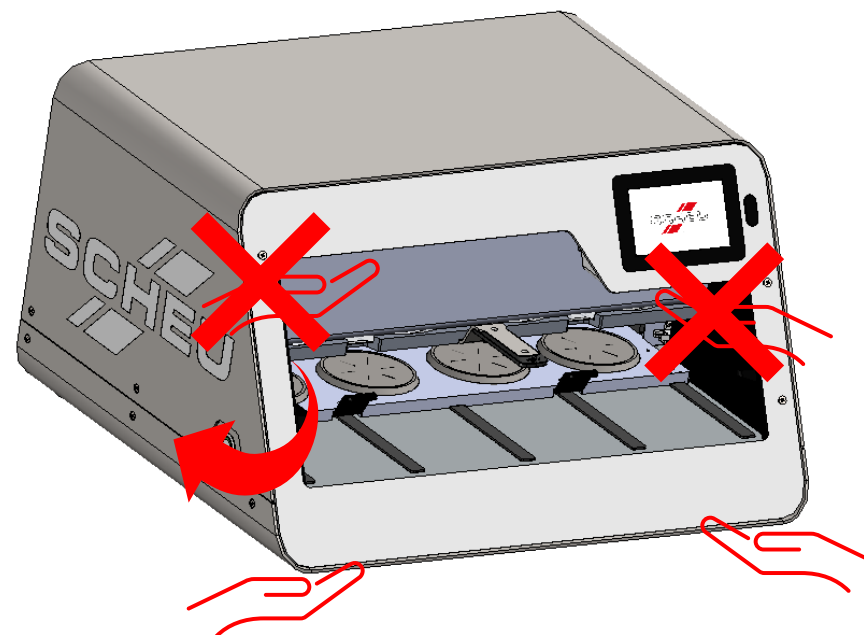

# Replacing ON/OFF switch 3030.966

**3**

Carefully insert a small screwdriver between the rocker switch and the power plug housing. Carefully lever out the rocker switch. Make sure that the cable lugs do not come loose. If the rocker switch cannot be removed for any reason, proceed to page 5.

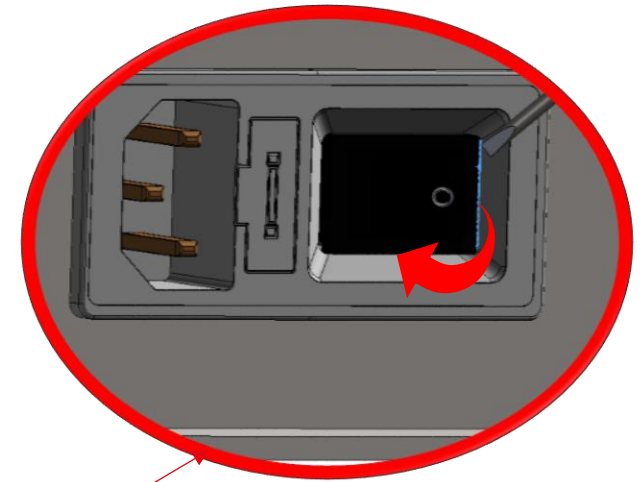
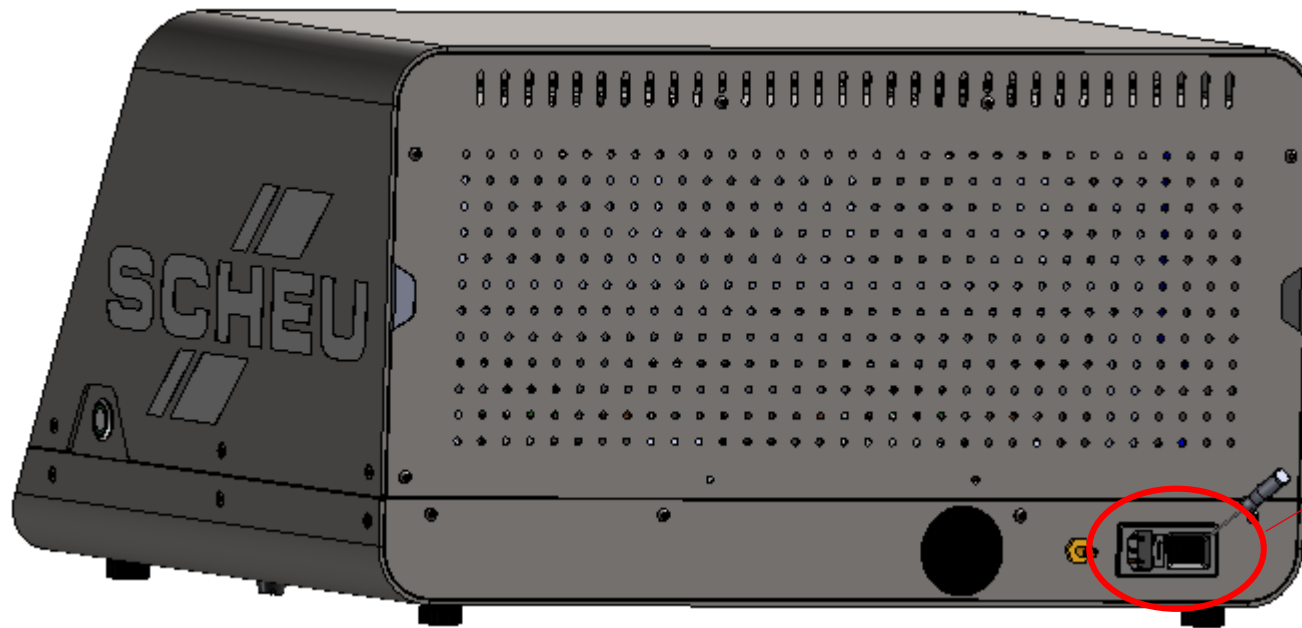

# Replacing ON/OFF switch 3030.966

4

Set the older connector aside and note the arrangement of the cable lugs.

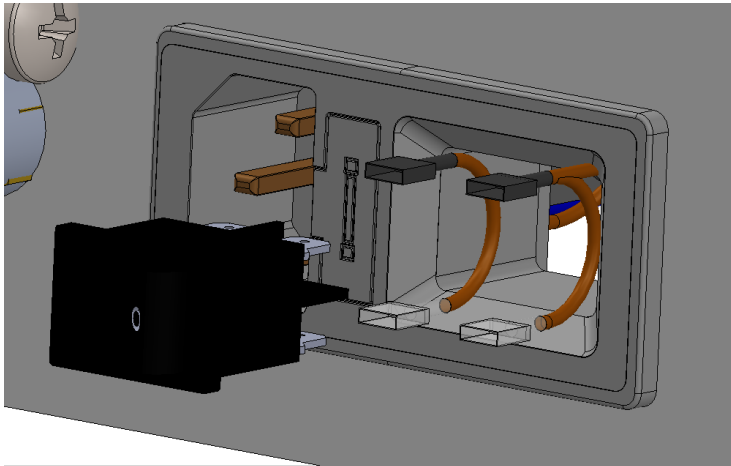

5

Take the new switch. Plug the cable lugs onto the contacts as shown in the illustration or as they were before. Push the switch evenly into the mains plug until it clicks into place. The 'I' mark on the rocker must face outwards (see illustration).

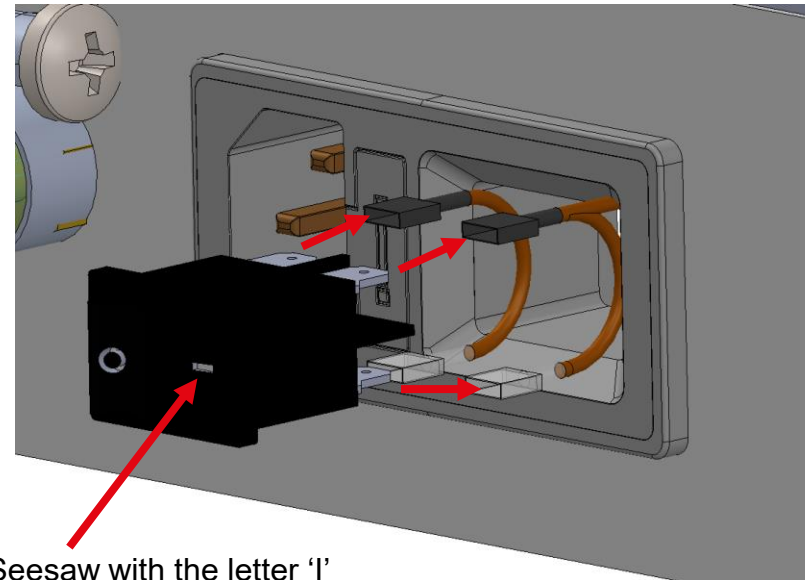

Seesaw with the letter 'I'  
pointing in this direction

# Replacing ON/OFF switch 3030.966

REPLACEMENT DEVICE PLUG COMPLETE!! 3030.912

6

*ATTENTION! The following steps are only necessary if the old rocker switch cannot be removed!!!*

Remove the 6 screws from the bottom of the housing and place the device on its side.

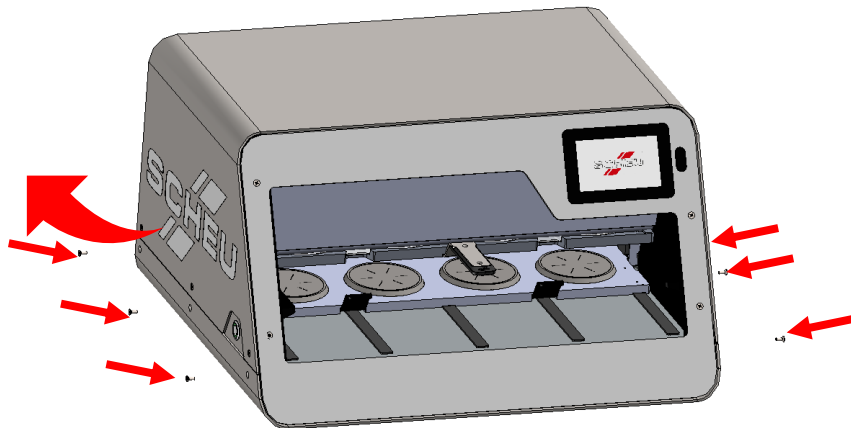

7

Unscrew the 7 housing feet, loosen the housing base and set everything aside.

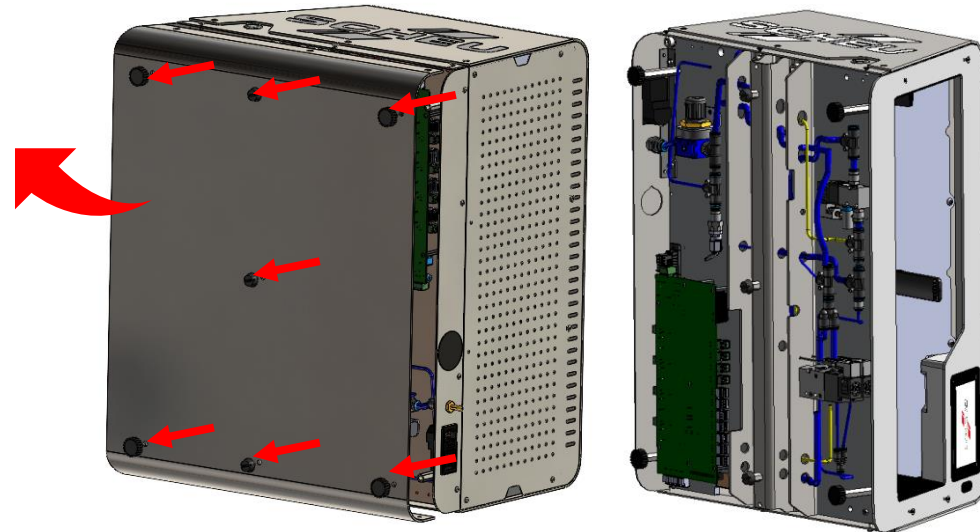

# Replacing ON/OFF switch 3030.966

REPLACEMENT DEVICE PLUG COMPLETE!! 3030.912

8

Position the device so that you can access the device plug from behind. Remove the cable lugs and press the plug slowly and evenly from the inside to the outside. If necessary, press the side tabs together while doing so.

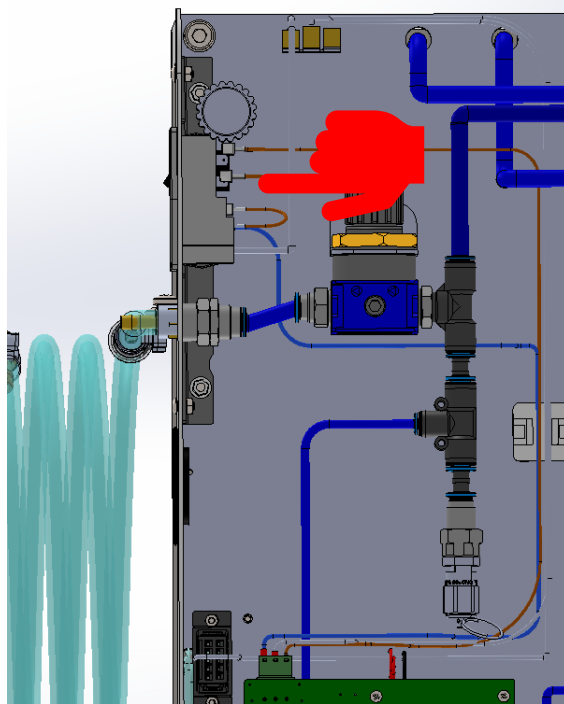

9

Push the rocker switch with the 'I' marking pointing towards the edge into the device plug evenly until it clicks into place.

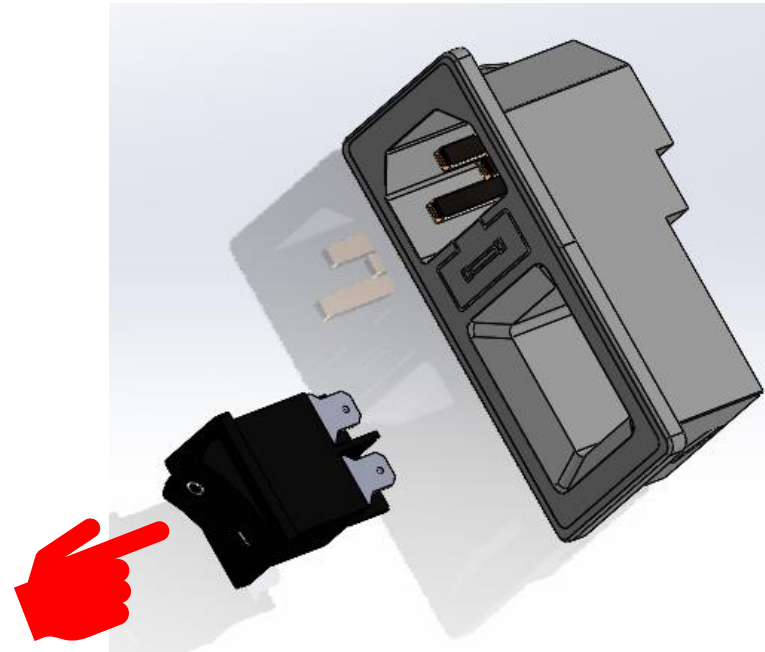

# Replacing ON/OFF switch 3030.966

REPLACEMENT DEVICE PLUG COMPLETE!! 3030.912

- 10** Now push the entire device plug evenly into the recess of the BIOSTAR 4 aligner until it clicks into place.

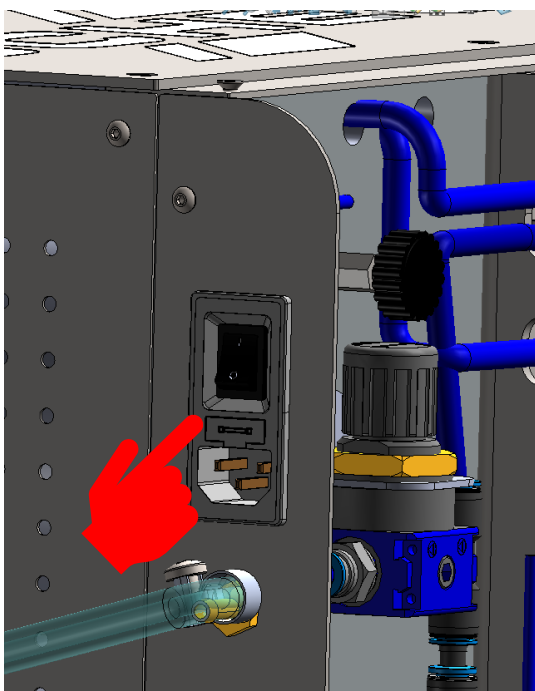

- 11** Attach the cable lugs to the contacts of the device plug and rocker switch according to the template.

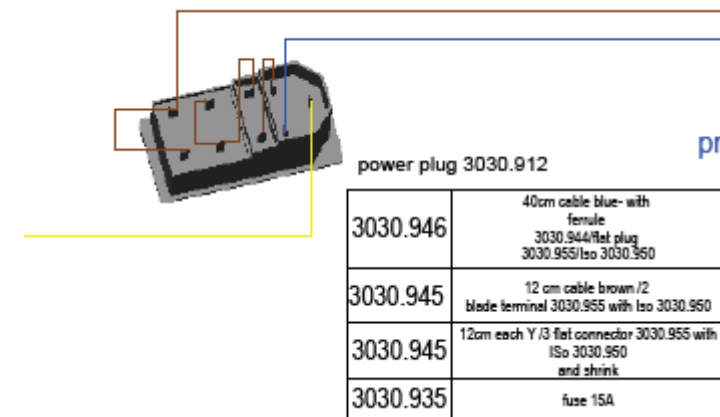
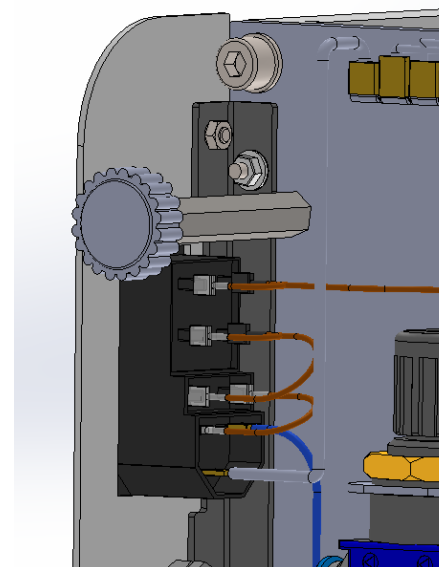

# Replacing ON/OFF switch 3030.966

REPLACEMENT DEVICE PLUG COMPLETE!! 3030.912

12

Replace the base plate and screw it to the side panels and the housing feet.

